

PRODUCT NUMBER	PITCH
YK601xx0x0JOG	10.00mm

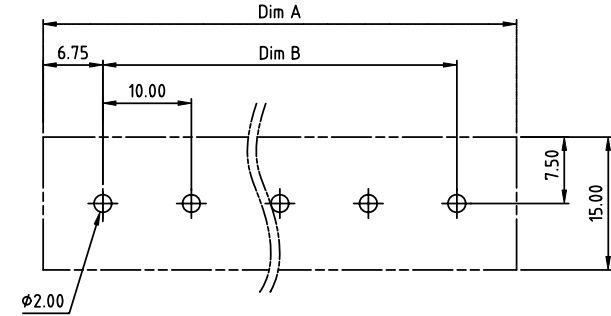

RECOMMENDED P.C.B LAYOUT
TOP VIEW

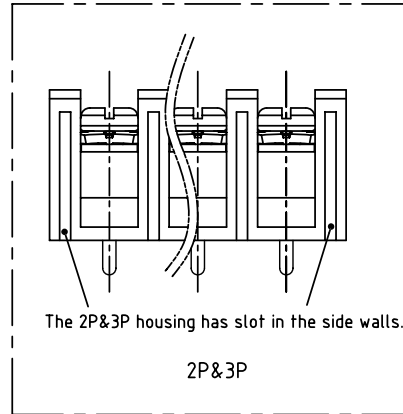
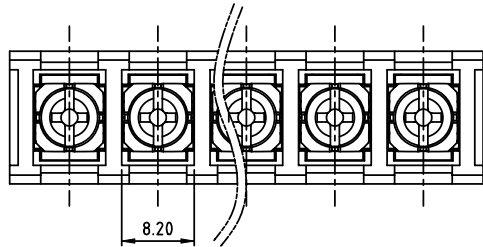
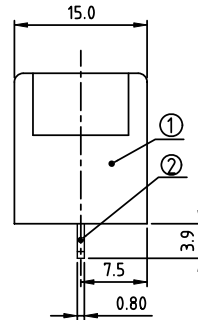
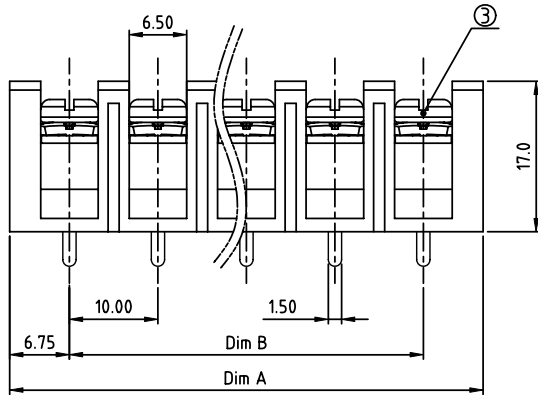

MATERIALS ELECTRICAL
 RATED VOLTAGE & CURRENT: 300 V, 20 A
 WITHSTAND VOLTAGE: AC 2000 V/Min
 INSULATION RESISTANCE: 1000 MΩ OR MORE AT DC 500 V
 OPERATING TEMPERATURE RANG: -40 °C ~ +115 °C
 SCREW TORQUE VALUE: 12Lb-In.
 WIRE RANGE: 22 - 12 AWG
 1) HOUSING: THERMOPLASTIC, UL 94 V-0 BLACK
 2) TERMINAL: BRASS, 0.8t
 3) SCREWS: STEEL, M3.5
 APPROVAL:

DIMENSION

Dim A	N×10.0±3.5
Dim B	(N-1)×10.0

N=Number of poles

Poles	Tolerance
2p-4p	±0.20
5p-10p	±0.30
11p-24p	±0.40
25p-30p	±0.50

PART NO.: YK 601xx 0 x 0 JOG

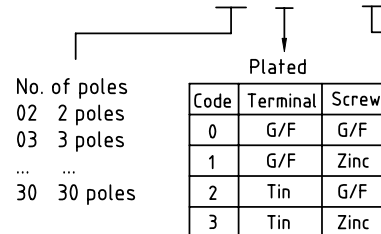

RoHS compliant
(lead<4%)
In copper Alloy

mat'l. code		surface ASME Y14.5	tolerance ASME Y14.5	projection 	product family TERMINAL BLOCK
ltr	ecn no	dr	date	tolerances unless otherwise specified	title TERMINAL BLOCK
				angles 	BARRIER TYPE
				X'±1"	scale
		dr	EVAN LU	061214	dwg no
		enr	EVAN LU	061214	sheet 1 of 1
		chr	HANKE FENG	061214	size A4
		appd	SHI JUN	061214	YK601xx0x0JOG
					type CUSTOMER Drawing
sheet index	revision	A			
	sheet	1			